

INSTALLATION INSTRUCTIONS FOR USE IN ROOFS

BreatherQuilt

1. VERTICAL JOINT

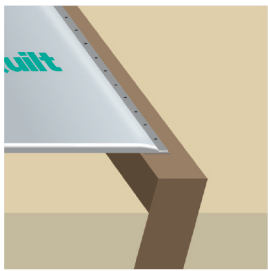

1.1 Unroll the BreatherQuilt over the top of the rafters. When you reach the end of the roll, cut the product so that it finishes in the middle of the last rafter, and staple in place.

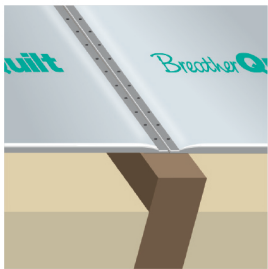

1.2 Begin the next roll from this rafter, by butt-jointing it to the end of the first roll and staple in place.

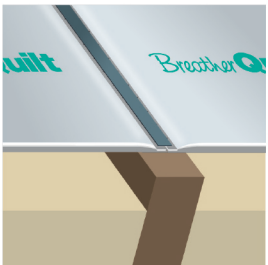

1.3 Using the **ThermaSeal™** 50mm Waterproof Tape, tape over the joint and ensure it is fully sealed.

GENERAL FIXING INSTRUCTIONS

Installation of BreatherQuilt for pitched roof applications and additional insulation products should be in accordance with the manufacturer's certificate, fixing instructions and current good building practice. Start at the bottom of the roof by rolling BreatherQuilt across the rafters and staple in to place. BreatherQuilt features an easy to use built-in tape feature which will be used to secure the next layer.

Install the next layer of BreatherQuilt over lapping the material by 100mm. Staple as before and ensure the overlap is sealed using the horizontal jointing method. Additional rolls should be butt jointed at the rafters, stapled as before and jointed using the vertical jointing method.

BreatherQuilt can be cut using a craft knife or sharp pair of scissors. Staple at regular intervals (approx. every 300mm). Minimum 14mm stainless steel or galvanised staples are recommended. No personal protective equipment, clothing or handling required.

2. HORIZONTAL JOINT



2.1 Start at the bottom of the roof by rolling BreatherQuilt across the rafters and staple in place. BreatherQuilt features an easy to use built-in tape with easy peel backing.

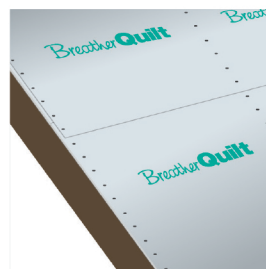

2.2 Roll the second roll of BreatherQuilt above the first roll, staple in place, maintaining a 100mm overlap (printed guideline). Fold the second roll back (100mm), remove the easy peel backing from the tape and secure in place by applying pressure.

Tel: 0114 323 0012

Email: sales@multifoil-insulation.com

Multifoil-Insulation.com

UK and European Distributors Specialising
in Multifoil Insulation Solutions

3. EAVES

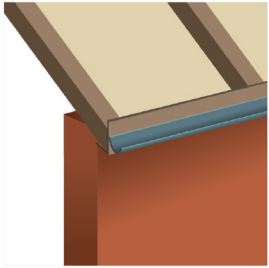

3.1 Install a suitable eaves carrier over the rafters so that it runs down into the gutter (to manufacturers guidelines)

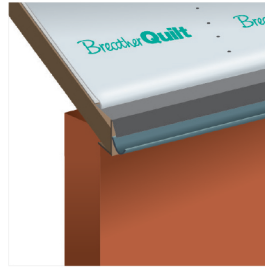

3.2 Install the BreatherQuilt over the rafters (see with 2.1), allowing the bottom edge to drape over the eaves carrier. Staple the product to the rafters, leaving the section over the eaves loose.

4. ROOFLIGHTS & CHIMNEYS

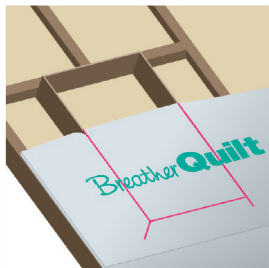

4.1 Lay the BreatherQuilt over the window and cut out the section within the frame of the window (as detailed in drawing) on the top layer of BreatherQuilt only and fold this back.

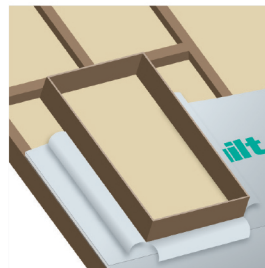

4.2 Carefully cut and remove the rest of the material around the window's edge.

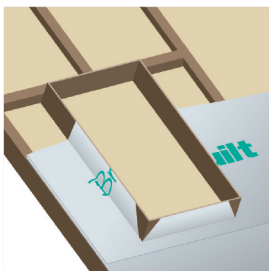

4.3 Fold the flaps back up to the sides of the window and staple in place. Proceed with the next layer ensuring to follow the horizontal jointing detail.

5. RIDGE - OVERLAPPED

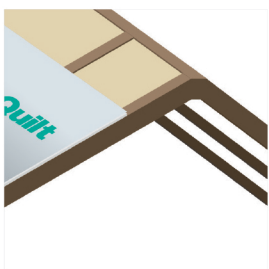

5.1 Install the BreatherQuilt on both sides of the roof.

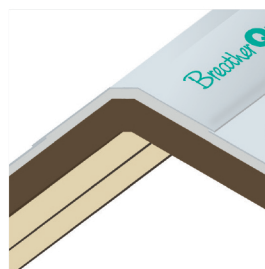

5.2 Roll out BreatherQuilt over the ridge ensuring that a minimum 100mm overlap is maintained to the BreatherQuilt on both sides. Seal the joints using the horizontal jointing method (see section 2).

6. RIDGE - CUT

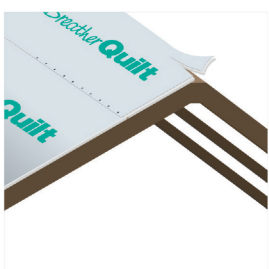

6.1 Roll out the BreatherQuilt and fix in place using staples. Cut along the centre of the ridge beam and staple to the ridge beam to secure.

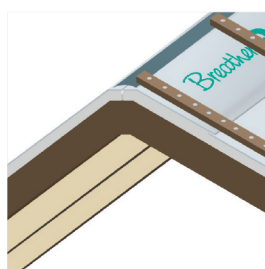

6.2 On the other side of the roof, roll out the BreatherQuilt and butt-joint to the first piece. Using the **ThermaSeal™** 50mm Waterproof Tape, tape over the joint and ensure it's fully sealed.

7. VALLEY

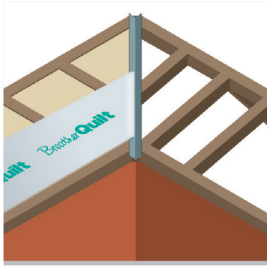

7.1 Install the BreatherQuilt over the rafters, allowing the edge to drape over the valley gutter. Staple the product to the rafters, leaving the section over the valley loose.

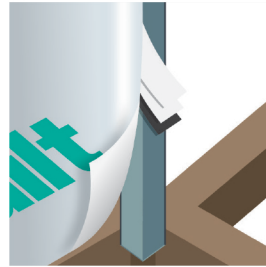

7.2 Pull back the breather membrane on the product and carefully cut away the rest of the insulation, leaving just the grey membrane in the valley.

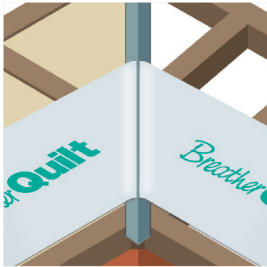

7.3 Continue installing the product up the valley in the same fashion.

8. HIP

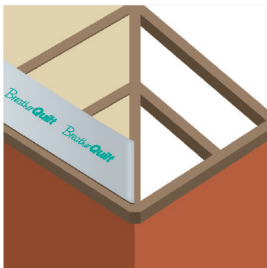

8.1 Install the BreatherQuilt over the rafters, cutting the product to sit on the hip on the roof, and staple in place.

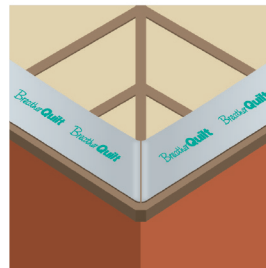

8.2 On the other side of the roof, roll out the BreatherQuilt and butt-joint to the first piece.

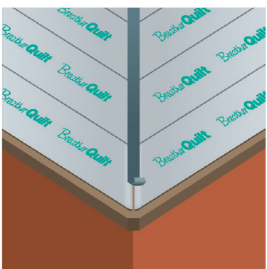

8.3 Continue installing the product up the hip in the same fashion. Follow vertical joint detail (see section 1) and horizontal joint detail (see section 2), ensuring it is fully sealed.

To Order online visit Multifoil-Insulation.com

Or by phone 0114 323 0012

Free Next Day Delivery On All Orders Over £100 + Vat!

Multifoil-Insulation.com

UK and European Distributors Specialising in
Multifoil Insulation Solutions